

Manual / Manuel

Central Repetidora Digital

Digital Control Panel Repeater

Centrale Répétiteur Digital

ZYR



ENGLISH

ASSEMBLY AND CONNECTION

The repeater must be fixed on a vertical wall face. The side slots must be left free for heat to escape. The dimensions and the pre-drilled holes for cable entry are shown in the **Figure 1**.

Lyon Control Panel

The two wires for the RS485 line are to be connected from the connector marked CONREP in the back panel of the control panel, to each connector of each repeater also marked like REPETITOR in the label. The two power supply wires are to be connected from the 30V output of the control panel's power supply to the connector indicated with 30V of each repeater. The repeaters must be connected as shown in **Figura 2**.

For power supply for up to 3 repeaters, the repeaters can be connected to the Lyon control panel's power supply 30V output. To power from 4 to 15 repeaters, the 30V output from an auxiliary power supply from the ZAFIRPWS range must be used.

When finalizing the installation is due to connect a resistance of 120 ohms in back panel of the last connected repeater.

Compact Lyon & Zafir Control Panel

The two wires for the RS485 line must be connected from the connector indicated as REPETITOR at the Control Panel, with each connector of the repeaters indicated as REPETITOR on the label. The two power supply wires must be connected from the 30V output of the Control Panel power supply, to the connector indicated with 30 V in each repeater. **Figure 3** shows this wiring diagram.

It can be used the Compact Lyon control panel's power supply 30V output for 1 repeater. In other cases (from 2 to 15 repeaters), it must be used the 30V output of an auxiliary power supply (ZAFIRPWS).

When finalizing the installation is due to connect a resistance of 120 ohms in back panel of the las connected repeater.

For repeaters connection, both the communication and 30V power supply cables must be 2 x 1.5 mm HALOGEN-FREE SCREENED BRAIDED CABLE, with a maximum cable length of 1200 metres.

**DISCONNECT the 230V MAINS voltage and the BATTERIES
before handling the inside of the control panel or the repeaters.**

OPERATION AND CONFIGURATION

The repeaters display all the information about alarms, disconnections, relay actuations and faults.

Once the repeaters have been connected, they must then be configured in the control panel by entering the number of each repeater to be configured. To do this, follow this sequence in the control panel: Menu (access code 27) → **4**. System configuration (access code 9000) → **8** Communications → **1** Repeater network → **2** Configure repeaters.

After configuring the control panel, a number must then be assigned to each repeater. This must be the same as the one which was configured in the control panel. To do this, follow this sequence in the corresponding repeater: Menu (access code 27) → **1** System configuration (access code 9000) → **3** Repeater number.

When configuration has been completed, the general system reset must be performed from the control panel. To do this, follow this sequence: Menu (access code 27) → **8** General reset. The zone labels must then be sent according to this sequence in the control panel: Menu (access code 27) → **1** System configuration (access code 9000) → **3** Configure → **7** Send Zones to Repeaters.

Functions that can be carried out from the repeater:

- Reset alarms and faults.
- Activate or deactivate silence sounders.
- Activate or deactivate evacuation.
- Activate or deactivate manual mode.
- Activate or deactivate delays.
- Deactivate the buzzer.
- General reset.

REPEATERS MENUS

The following menus are accessible in the repeater:

- **SYSTEM CONFIGURATION**
 - **ADDITIONAL PASSWORDS:** From this menu, an additional password can be entered for access level 2 and another password for access level 3. Every time a new password is entered, the password entered previously will be deleted. The passwords which came pre-installed from the factory (access level 2: **27**; and in access level 3: **9000**) cannot be deleted.
 - **LANGUAGES MENU:** From this menu, the repeater's language can be selected. The repeater will be provided with seven languages: Castilian, English, French, Italian, Hungarian, Ukrainian and Portuguese.
 - **REPEATER NUMBER:** From this menu, the repeater number to be used when communicating with the control panel can be selected. This number can never be used in more than one repeater.
- **GENERAL RESET:** From this option, the whole system can be reset. When the system is reset, all the events are deleted from the control panel and the repeaters, i.e. alarms, faults and relay actuations. The status of the elements and/or zones that are out of service is maintained.
- **SYSTEM TEST:** This option is used to test the repeater's indicators. In this test, all the leds should light up, the buzzer should sound, and the following screen should be displayed:

- **WELCOME MESSAGE:** From this option it is allowed to change the welcome message. The welcome message is the text that appears in forward edge when the repeater is in rest. This message must have a maximum of 40 characters which we will be introducing by means of the cursors of the repeater or a n external keyboard.

NOTE:

COFEM S.A. reserves the right to carry out changes due to typographical errors, print outs of the current information or improvements to programmes and/or equipment at any time and without prior consent.



Figura / Figure 1



Figura / Figure 2

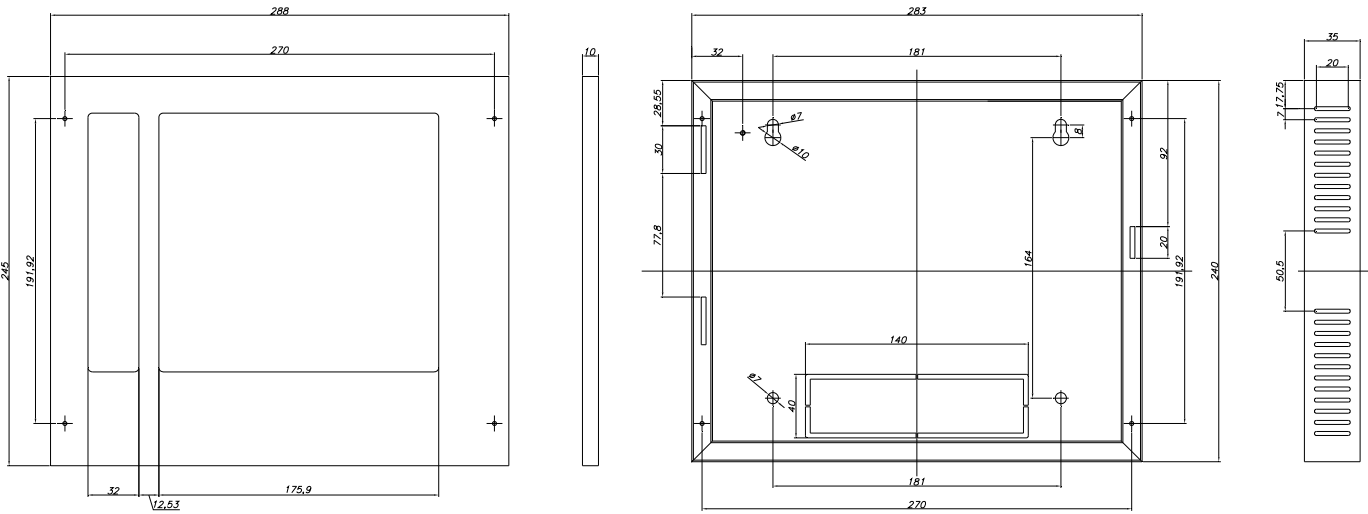
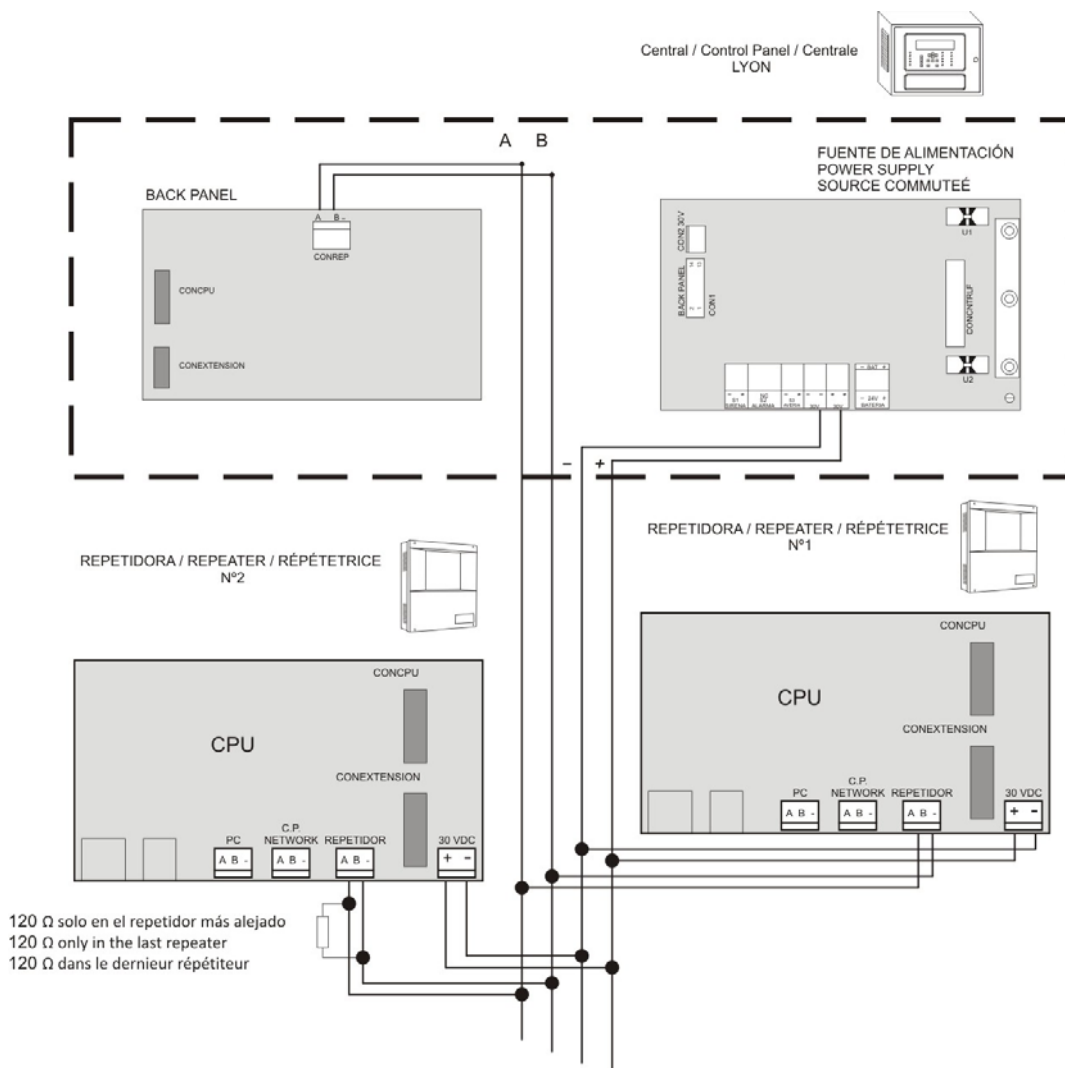
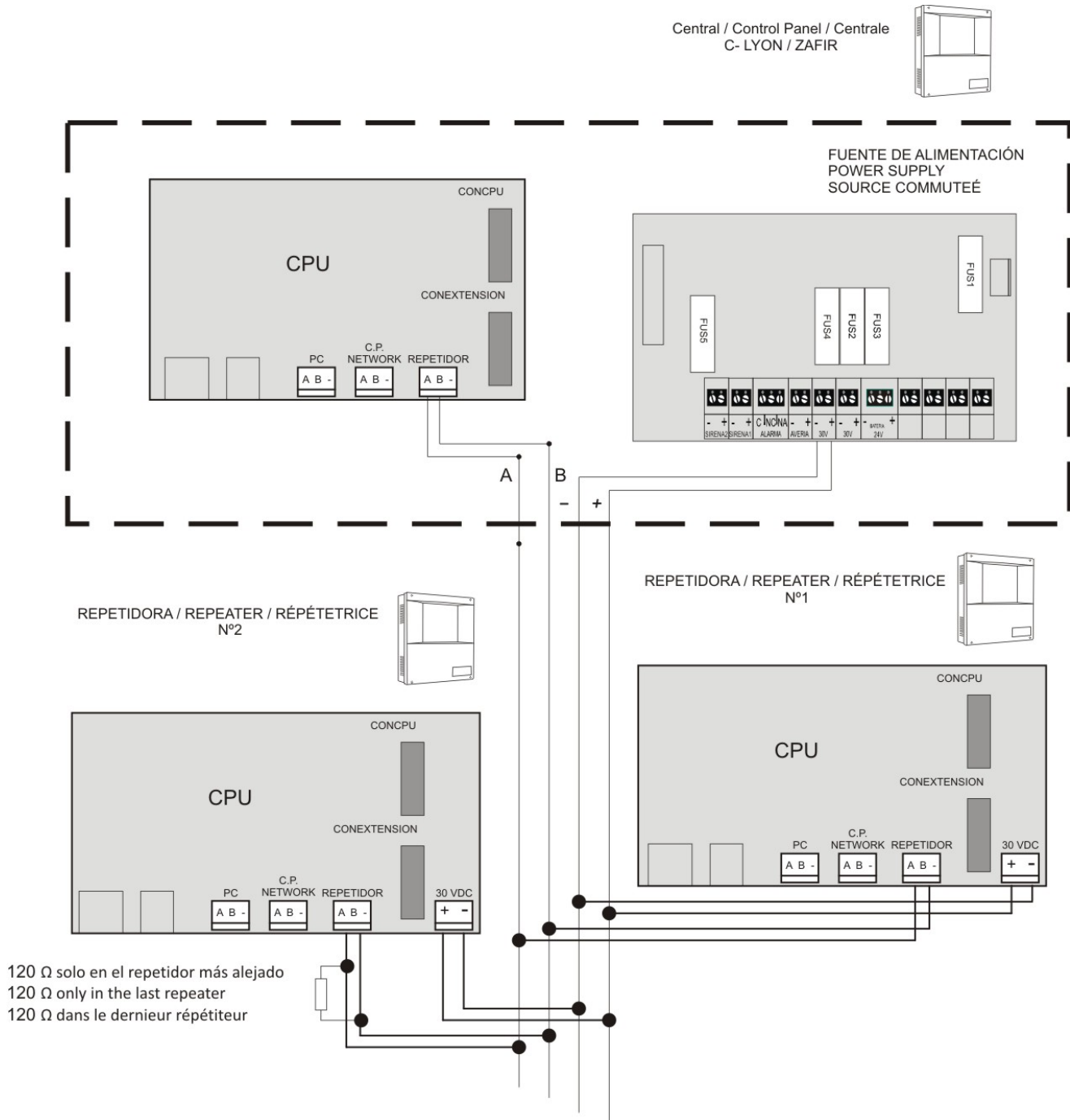

Figura / Figure 3